



Feature

- Powered by high output PHILIPS LED.
- Constant Current.
- Integrated transparent 170° optic lens.
- 30/20 pcs per string.
- CE, RoHS, UL, TUV, BIS, CB and LM-80 certified.

Application

- Apply to 6-15 cm depth signs at airports, metros, banks, buildings and shopping malls, etc.

Parameters

Items	Parameters			
Part Number	EV-BLPG01LBY-CW	EV-BLPG02LBY-CW	EV-BLPG03LBY-CW	EV-BLPG04LBY-CW
CCT (K)	6500K	6500K	6500K	6500K
Beaming Angle (°)	170°	170°	170°	170°
CRI (Ra)	≥75	≥75	≥75	≥75
Luminous Flux (lm)	60	110	165	180
Voltage (V)	DC12	DC12	DC12	DC12
Power (W)	0.36	0.72	1.08	1.2
Driving Method	Constant Current	Constant Current	Constant Current	Constant Current
Dimension (mm)	17.4*23*9.6	52*18.5*9.6	78*18.5*9.6	42.1*42.1*9.6
Working Tem. (°C)	-25 ~ +60	-25 ~ +60	-25 ~ +60	-25 ~ +60
Storage Tem. (°C)	-25 ~ +70	-25 ~ +70	-25 ~ +70	-25 ~ +70
Protection Grade	IP66	IP66	IP66	IP66

■ **Dimension (Unit:mm)**

EV-BLPG01LBY-CW

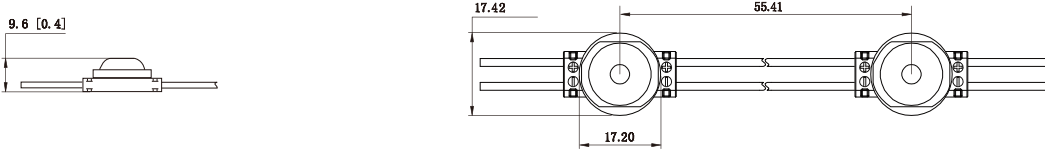

EV-BLPG02LBY-CW

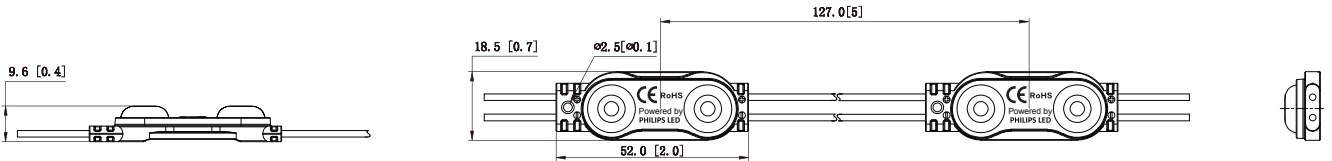

EV-BLPG03LBY-CW

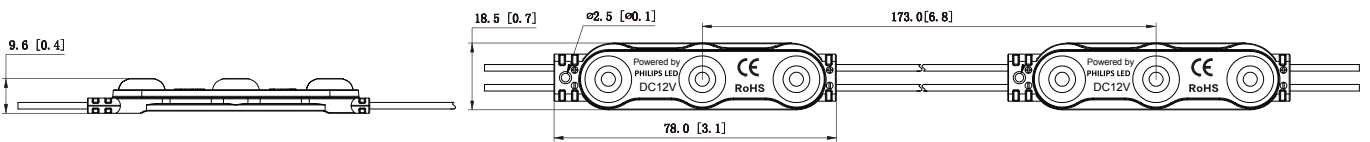

EV-BLPG04LBY-CW

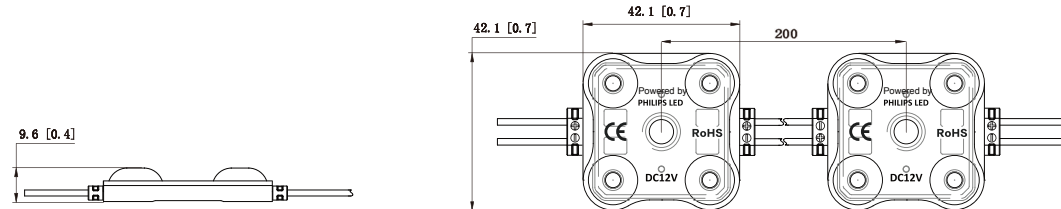

■ **Beaming Angle**

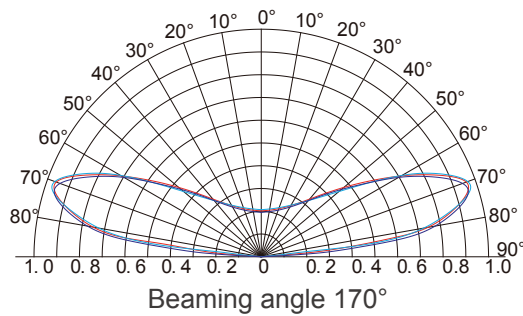

Reference Scheme

Part Number	Depth(mm)	Max. Spacing(mm)	Density(pcs/m ²)	Illumination(lux)
EV-BLPG01LBY-CW	Dz=30	Dx=60 Dy=50	340	3500
	Dz=40	Dx=80 Dy=90	179	2800
	Dz=60	Dx=100 Dy=90	111	3400
	Dz=80	Dx=110 Dy=100	91	1800

Part Number	Depth(mm)	Max. Spacing(mm)	Density(pcs/m ²)	Illumination(lux)
EV-BLPG01LBY-CW	Dz=60	Dx=100 Dy=90	111	6000
	Dz=80	Dx=120 Dy=110	76	5500
	Dz=100	Dx=140 Dy=130	55	4700
	Dz=120	Dx=160 Dy=150	42	3100
	Dz=140	Dx=160 Dy=150	42	2500

Part Number	Depth(mm)	Max. Spacing(mm)	Density(pcs/m ²)	Illumination(lux)
EV-BLPG03LBY-CW	Dz=60	Dx=100 Dy=130	77	5300
	Dz=80	Dx=120 Dy=150	55	4700
	Dz=100	Dx=140 Dy=170	39	4200
	Dz=120	Dx=160 Dy=170	31	3500
	Dz=140	Dx=180 Dy=170	31	3000

Part Number	Depth(mm)	Max. Spacing(mm)	Density(pcs/m ²)	Illumination(lux)
EV-BLPG04LBY-CW	Dz=60	Dx=130 Dy=130	59	5500
	Dz=80	Dx=150 Dy=150	44	5300
	Dz=100	Dx=170 Dy=170	35	4400
	Dz=120	Dx=190 Dy=190	28	3200
	Dz=140	Dx=190 Dy=190	28	2900

Remark:

- 01. The transmittance of the advertising fabric was 30%.
- 02. The above data is for reference only

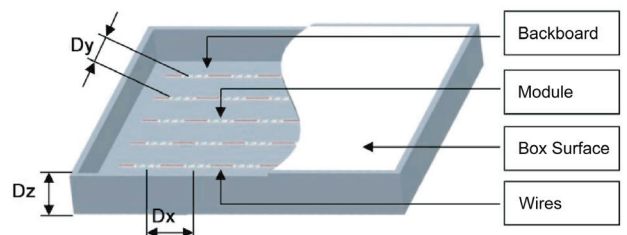

■ **Wire Connection**

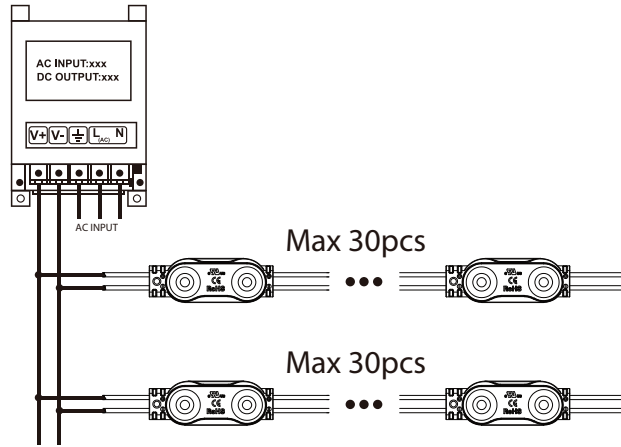

■ **Packing**

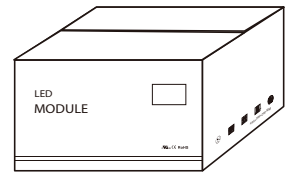
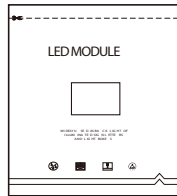
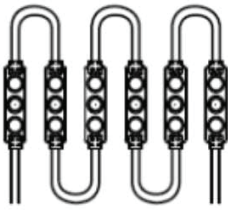

EV-BLPG01LBY-CW 30 pcs per string
EV-BLPG02LBY-CW 30 pcs per string
EV-BLPG03LBY-CW 20 pcs per string
EV-BLPG04LBY-CW 20 pcs per string

300 pcs in per bag
 180 pcs in per bag
 120 pcs in per bag
 80 pcs in per bag

3300 pcs in a carton
 1800 pcs in a carton
 1200 pcs in a carton
 800 pcs in a carton

■ **Packing Specification**

- Antistatic bag adopted
- Packing information

Part Number	EV-BLPG01LBY-CW	EV-BLPG01LBY-CW	EV-BLPG03LBY-CW	EV-BLPG04LBY-CW
Carton Dimension (mm)	490*450*220	490*450*220	490*450*220	490*450*220
Bags Per Carton	10	10	10	10
Quantity Per Carton (pcs)	3300	1800	1200	800
Net Weight (kg)	18.5(1±10%)	22(1±10%)	19.8(1±10%)	17.6(1±10%)
Gross Weight (kg)	20.5(1±10%)	24(1±10%)	21.8(1±10%)	19.9(1±10%)

Due to the packing manner difference, please adhere to the original products in case of discrepancy found between the picture and actual product.

■ **Self-provided tools & material**

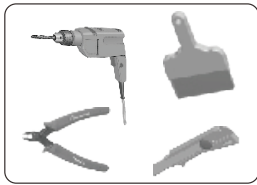

Dust brush, cutter, pencil, wire stripper, and drill

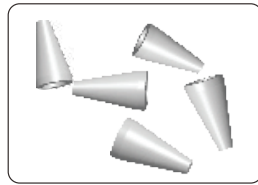

Wire Connector (Standard)

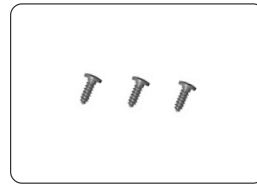

Screw

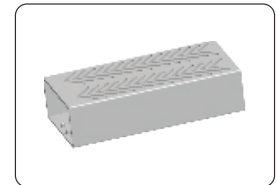

Power Supply

■ **Installation Guidance**

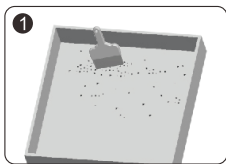

- Clean inside the light box.

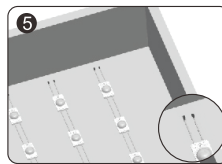

- Strip the end wire for 10mm and cap with the wire connector. Waterproof and anti-corrosion must be done on the connectors.

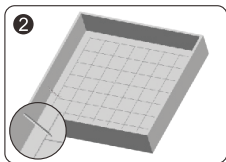

- Determine the appropriate layout.

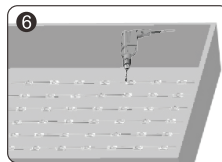

- Locate modules in the optimal position and secure with screws or neutral glass cement, which should be applied at the edge of the modules.
- ⚠ Note: Avoid breaking the module and wire when fixing with a drill.

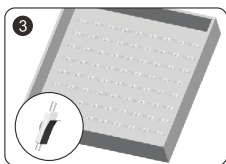

- Peel tape backing and stick modules into place.

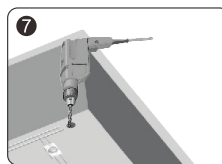

- Drill a hole for connecting power cable. Fixation and protection for the cable must be done on the hole.
- ⚠ Note: Avoid breaking the light box in drilling the hole.

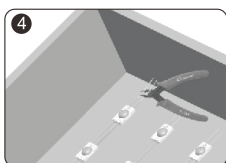

- Remove the unneeded modules.
- ⚠ Note: Cut in the middle position of the wires between modules.

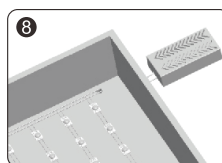

- Connect to the power cable and make sure that the polarity for connection is correct.
- ⚠ Note: Red wire is positive and black wire is negative.

■ Instructions

01. Make sure the input voltage is sufficient 12V.
02. Disassembling or modifying the product is not allowed.
03. Installation with power on is not allowed.
04. Any organic solvent chemical is not allowed.
05. Acidic or alkaline adhesive is not allowed when install, neutral glass cement could be used for installation purpose, make it drying in open environment for four hours.
06. Isolation and corrosion prevention on all wiring points and wire ends.
07. Make sure the power wire is thick enough and ensure the input voltage and connections are correct before power on.
08. This product should be used in a sign, do not expose it in opening site.
09. Installation and maintaining should be done by professional staff.
10. Maximum 30/20 pcs in a serial connection.
11. Initial location with 3M tape, then secure with screws.

■ Declaration

01. Warranty: 5 years.
02. In order to ensure the safety, the broken wires need to be replaced by the manufacturer or the service agent, or by the staff with the similar qualification.
03. The given data in the specification was based on the laboratory testing, there may be discrepancy found in the actual products.
04. The given drawings in the specification are only for reference, there may be discrepancy found in the actual products.
05. The products are subject to change without prior notification.