

# Cable Glands - M Series

케이블그랜드 / 电缆防护接头 - M 系列

**NEW** ▶ BC-M-MULTI HOLE

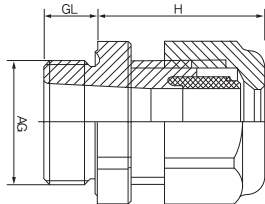

Model No.	Thread (AG)	Cable Ø (mm)	H (mm)	GL (mm)	Wrench (mm)
<b>Black</b>					
<b>BC-M-1 MULTI HOLE</b>					
BC-1H-M12-B	M12	4.5-8	34	9	19
BC-1H-M16-B	M16	6-10	42	5	22
BC-1H-M20-B	M20	9-14	48	15	27
BC-1H-M25-B	M25	13-18	49	15	33
BC-1H-M32-B	M32	18-25	56	15	42
BC-1H-M40-B	M40	24-32	65	20	52
BC-1H-M50-B	M5	31-41	73	22	62
BC-1H-M63-B	M63	44-51	78	25	75
BC-1H-M75-B	M75	56-66	81	25	92
BC-1H-M90-B	M90	66-77	82	25	110
<b>BC-M-2 MULTI HOLE</b>					
BC-2H-M12-B	M12	1.5-3	34	9	19
BC-2H-M16-B	M16	2-4	42	15	22
BC-2H-M20-B	M20	3-6	48	15	27
BC-2H-M25-B	M25	5-8	49	15	33
BC-2H-M32-B	M32	7-11	56	15	42
BC-2H-M40-B	M40	10-13	65	20	52
<b>BC-M-3 MULTI HOLE</b>					
BC-3H-M12-B	M12	1.5-2.5	34	9	19
BC-3H-M16-B	M16	2-4	42	15	22
BC-3H-M20-B	M20	3-5	48	15	27
BC-3H-M25-B	M25	4.5-7	49	15	33
BC-3H-M32-B	M32	7-10	56	15	42
BC-3H-M40-B	M40	9-12	65	20	52
<b>BC-M-4 MULTI HOLE</b>					
BC-4H-M12-B	M12	1.5-2.5	34	9	19
BC-4H-M16-B	M16	1.5-3	42	15	22
BC-4H-M20-B	M20	2.5-4.5	48	15	27
BC-4H-M25-B	M25	4-6	49	15	33
BC-4H-M32-B	M32	8-9	56	15	42
BC-4H-M40-B	M40	8-11	65	20	52
<b>BC-M-5 MULTI HOLE</b>					
BC-5H-M16-B	M16	1-2.5	42	15	22
BC-5H-M20-B	M20	2-4	48	15	27
BC-5H-M25-B	M25	3.5-5.5	49	15	33
BC-5H-M32-B	M32	5.5-8	56	15	42
BC-5H-M40-B	M40	7-9.5	65	20	52
<b>BC-M-6 MULTI HOLE</b>					
BC-6H-M16-B	M16	1-2	42	15	22
BC-6H-M20-B	M20	1.5-3	48	15	27
BC-6H-M25-B	M25	2.5-4.5	49	15	33
BC-6H-M32-B	M32	5-7	56	15	42
BC-6H-M40-B	M40	6-8	65	20	52

• Feature / 특성 / 特征

1. Material / 재질 / 材质 : PA (NYLON)
2. Hermetic seal / 밀봉 실 / 密封圈 : NBR
3. Washer / 와셔 / 平垫 : NBR
4. Color / 색상 / 颜色 : Black

- Dimensions and specifications are subject to change without notice.
- 규격 및 사양은 사전 예고 없이 변경될 수 있습니다.
- 厂家会在没有任何提前通知的情况下更改产品规格与样式。

▶ BC-M CABLE GLAND

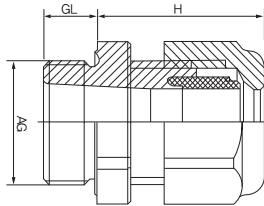

Model No.			Thread (AG)	Cable Ø (mm)	H (mm)	GL (mm)	Wrench (mm)
Grey	Dark Grey	Black					
BC-M12-G	BC-M12-D	BC-M12-B	M12x1.5	3-6.5	21	8	15
BC-M16-G	BC-M16-D	BC-M16-B	M16x1.5	4-8	21	8	18
BC-M18-G	BC-M18-D	BC-M18-B	M18x1.5	5-10	24	8	21
BC-M20-G	BC-M20-D	BC-M20-B	M20x1.5	6-12	27	9	23
BC-M22-G	BC-M22-D	BC-M22-B	M22x1.5	10-14	28	10	26
BC-M24-G	BC-M24-D	BC-M24-B	M24x1.5	12-16	30	10	26
BC-M25-G	BC-M25-D	BC-M25-B	M25x1.5	13-18	31	10	31
BC-M27-G	BC-M27-D	BC-M27-B	M27x1.5	13-18	31	10	32
BC-M30-G	BC-M30-D	BC-M30-B	M30x1.5	16-21	35	10	34
BC-M32-G	BC-M32-D	BC-M32-B	M32x1.5	18-25	39	11	34
BC-M36-G	BC-M36-D	BC-M36-B	M36x1.5	18-25	42	12	40
BC-M40-G	BC-M40-D	BC-M40-B	M40x1.5	22-32	48	13	50
BC-M50-G	BC-M50-D	BC-M50-B	M50x1.5	32-38	49	13	60
BC-M63-G	BC-M63-D	BC-M63-B	M63x1.5	37-44	49	14	66

• Feature / 특성 / 特征

1. Material / 재질 / 材质 : PA (NYLON)
2. Hermetic seal / 밀봉 실 / 密封圈 : NBR
3. Washer / 와샤 / 平垫 : NBR
4. Color / 색상 / 颜色 : Grey, Black, Dark grey

▶ BC-M-L LONG CABLE GLAND

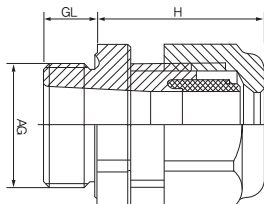

Model No.	Thread (AG)	Cable Ø (mm)	H (mm)	GL (mm)	Wrench (mm)
Grey					
BC-M12L-G	M12x1.5	3-6.5	21	15	15
BC-M16L-G	M16x1.5	4-8	22	15	19
BC-M18L-G	M18x1.5	5-10	27	15	22
BC-M20L-G	M20x1.5	6-12	27	15	24
BC-M22L-G	M22x1.5	10-14	30	15	27
BC-M25L-G	M25x1.5	13-18	31	15	33
BC-M32L-G	M32x1.5	18-25	39	15	42

• Feature / 특성 / 特征

1. Material / 재질 / 材质 : PA (NYLON)
2. Hermetic seal / 밀봉 실 / 密封圈 : NBR
3. Washer / 와샤 / 平垫 : NBR
4. Color / 색상 / 颜色 : Grey

- Dimensions and specifications are subject to change without notice.
- 규격 및 사양은 사전 예고 없이 변경될 수 있습니다.
- 厂家会在没有任何提前通知的情况下更改产品规格与样式。

▶ **BC-BP-M BEND PROOF CABLE GLAND**



Model No.	Thread (AG)	Cable Ø (mm)	H (mm)	GL (mm)	Wrench (mm)
BC-BP-M12-G	M12	3-6.5	66	8	16
BC-BP-M16-G	M16	4-8	75	9	19
BC-BP-M18-G	M18	5-10	82	9	22
BC-BP-M20-G	M20	7-12	87	10	24
BC-BP-M22-G	M22	8-13	96	10	27
BC-BP-M25-G	M25	13-18	110	10	33

• Feature / 특성 / 特征

1. Material / 재질 / 材质 : PA (NYLON)
2. Hermetic seal / 밀봉 실 / 密封圈 : NBR
3. Washer / 와셔 / 平垫 : NBR
4. Color / 색상 / 颜色 : Grey

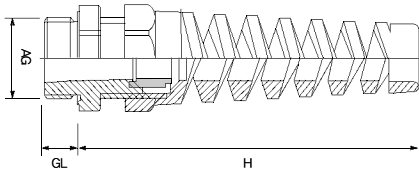

▶ **BC-SP-M SCREW PLUG**



Model No.	D1 (mm)	H (mm)	GL (mm)	Wrench (mm)
BC-SP-M12	M12	12.2	9	16
BC-SP-M16	M16	12.2	9	20
BC-SP-M18	M18	12	9	22
BC-SP-M20	M20	14.6	11	25
BC-SP-M22	M22	14.6	11	27
BC-SP-M25	M25	14.6	11.2	30
BC-SP-M27	M27	15	11.2	33
BC-SP-M32	M32	15	11	38
BC-SP-M40	M40	16	12	46
BC-SP-M50	M50	16.8	12	56
BC-SP-M63	M63	16.2	12	69.0

• Feature / 특성 / 特征

1. Material / 재질 / 材质 : PA (NYLON)
2. Color / 색상 / 颜色 : Grey

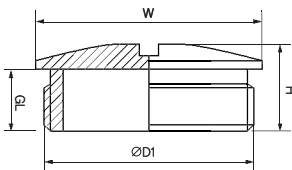

- Dimensions and specifications are subject to change without notice.
- 규격 및 사양은 사전 예고 없이 변경될 수 있습니다.
- 厂家会在没有任何提前通知的情况下更改产品规格与样式。

▶ BC-MM METAL CABLE GLAND

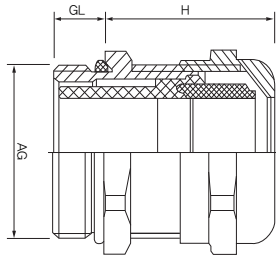

Model No.	Thread (AG)	Cable Ø (mm)	H (mm)	GL (mm)	Wrench (mm)
BC-MM12	M12	4-7	22	6	14
BC-MM16	M16	5-8	26	7	18
BC-MM18	M18	6-10	28	7	20
BC-MM20	M20	8-12	30	8	22
BC-MM22	M22	11-14	30	8	24
BC-MM24	M24	10-14	30	8	27
BC-MM25	M25	11-14	34	9	24
BC-MM27	M27	13-18	34	8	30
BC-MM30	M30	13-18	34	8	34
BC-MM32	M32	16-22	38	11	34
BC-MM36	M36	18-25	42	9	40
BC-MM40	M40	23-28	41	12	45
BC-MM50	M50	25-32	49	10	58
BC-MM63	M63	37-44	50	13	64

• Feature / 특성 / 特征

1. Material / 재질 / 材质 : Nickel-plated brass
2. Hermetic seal / 밀봉 실 / 密封圈 : NBR

▶ BC-MM-L METAL LONG CABLE GLAND

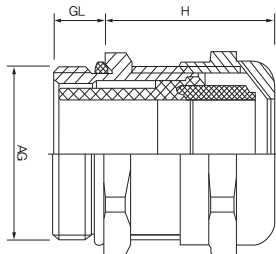

Model No.	Thread (AG)	Cable Ø (mm)	H (mm)	GL (mm)	Wrench (mm)
BC-MM12L	M12	4-7	27	10	14
BC-MM16L	M16	5-8	31	10	18
BC-MM18L	M18	6-10	33	10	20
BC-MM20L	M20	8-12	35	10	22
BC-MM22L	M22	10-14	35	10	24
BC-MM24L	M24	10-14	35	11	24
BC-MM25L	M25	11-14	38	12	24
BC-MM27L	M27	3-18	38	12	30
BC-MM30L	M30	13-18	38	14	34
BC-MM32L	M32	16-22	42	14	34
BC-MM36L	M36	18-25	47	14	40
BC-MM40L	M40	23-28	48	15	45
BC-MM50L	M50	25-32	54	16	58
BC-MM63L	M63	37-44	55	16	64

• Feature / 특성 / 特征

1. Material / 재질 / 材质 : Nickel-plated brass
2. Hermetic seal / 밀봉 실 / 密封圈 : NBR

- Dimensions and specifications are subject to change without notice.
- 규격 및 사양은 사전 예고 없이 변경될 수 있습니다.
- 厂家会在没有任何提前通知的情况下更改产品规格与样式。

▶ **BC-MSP-M METAL SCREW PLUG**



Model No.	D1 (mm)	H (mm)	GL (mm)	Wrench (mm)
BC-MSP-M12	M12x1.5	9.7	6	14
BC-MSP-M16	M16x1.5	9	6	18
BC-MSP-M18	M18x1.5	10	6.5	20
BC-MSP-M20	M20x1.5	11.5	8	22
BC-MSP-M22	M22x1.5	10.5	7	24
BC-MSP-M25	M25x1.5	11.3	9	27
BC-MSP-M32	M32x1.5	10.7	7.5	34
BC-MSP-M40	M40x1.5	12.5	8	42
BC-MSP-M50	M50x1.5	14	10	52
BC-MSP-M63	M63x1.5	15	10.5	67

• Feature / 특성 / 特征

1. Material / 재질 / 材质 : PA (NYLON)

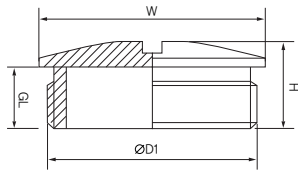

**NEW** ▶ **BC-MRH-M Metal Reducer**



Model No.	Thread A	Thread G	L (mm)	H (mm)
BC-MRH-M1612	M16x1.5	M12x1.5	5	8
BC-MRH-M2012	M20x1.5	M12x1.5	6	9
BC-MRH-M2016	M20x1.5	M16x1.5	6	9
BC-MRH-M2516	M25x1.5	M16x1.5	7	10
BC-MRH-M2510	M25x1.5	M20x1.5	7	10
BC-MRH-M3216	M32x1.5	M16x1.5	8	11
BC-MRH-M3220	M32x1.5	M20x1.5	8	11
BC-MRH-M3225	M32x1.5	M25x1.5	8	11
BC-MRH-M4020	M40x1.5	M20x1.5	8	12
BC-MRH-M4025	M40x1.5	M25x1.5	8	12
BC-MRH-M4032	M40x1.5	M32x1.5	8	12
BC-MRH-M5025	M50x1.5	M25x1.5	9	13
BC-MRH-M5032	M50x1.5	M32x1.5	9	13
BC-MRH-M5040	M50x1.5	M40x1.5	9	13
BC-MRH-M6332	M63x1.5	M32x1.5	10	14
BC-MRH-M6340	M63x1.5	M40x1.5	10	14
BC-MRH-M6350	M63x1.5	M50x1.5	10	14

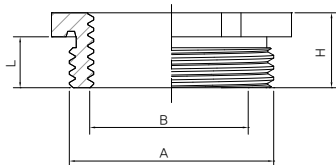

• Feature / 특성 / 特征

1. Material / 재질 / 材质 : Nickel-plated brass / 니켈도금황동 / 外部金属为黄铜镀镍

- Dimensions and specifications are subject to change without notice.
- 규격 및 사양은 사전 예고 없이 변경될 수 있습니다.
- 厂家会在没有任何提前通知的情况下更改产品规格与样式。